

LIFTING EYEBOLTS

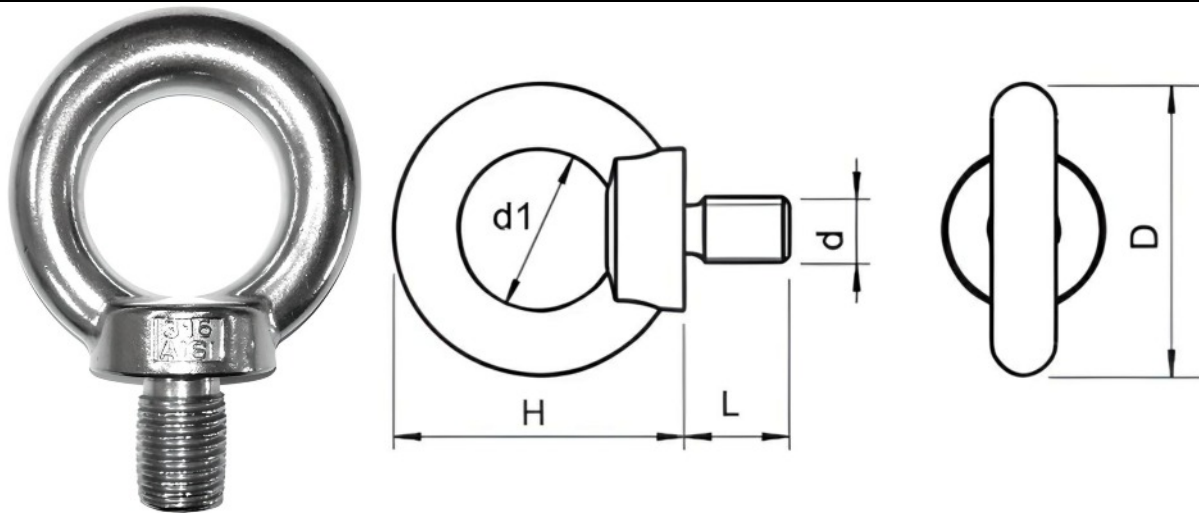

D	CODE	D	d1	H	L
M6	SKU9002	27	16	31	11
M8	SKU9004	36	20	36	13
M10	SKU9006	45	25	45	17
M12	SKU9008	54	30	53	20.5
M16	SKU9010	63	35	62	27
M20	SKU9012	72	40	71	30
M24	SKU9014	90	50	90	36
M30	SKU9016	108	60	109	45
M36	ASK	126	70	128	54

Notes : Dimensions are a guide and may vary slightly. Pls check with us for dimension critical applications.

If Break (BL), Safe working load (SWL) or Working load limit (WLL) are shown:

This is a guide only. (Do not use for lifting unless it is a certified lifting product)

LIFTING EYEBOLTS - DIN580 TYPE

These eyebolts can be used for tethering or towing , but are not to be used for overhead lifting as they are not a CE certified lifting product. Use these as a cheaper alternative to genuine DIN580 forged certified eyebolts, where lifting is not required.

MATERIAL TYPE	A2 / A4 STAINLESS
FINISH	POLISHED

- Good for various applications
- Highly durable