



# **STEEL GEAR**

## **GALVANISED DEE SHACKLE**



## **DATASHEET**

**STEELGEAR.CO.UK  
UNIT 9 THESIGER CLOSE  
WORTHING  
BN11 2RN**

**[www.steelgear.co.uk](http://www.steelgear.co.uk)  
[info@steelgear.co.uk](mailto:info@steelgear.co.uk)**

# SPECIFICATION :



## GALVANISED DEE SHACKLE

Galvanised Dee shackle made to U.S. Fed spec. RR-C-271. Every shackle has a safe working load limit which is embossed onto the shackle. It has a screw pin lock which is common with many types of shackles.

MATERIAL	GALVANISED
MATERIAL TYPE	GALVANISED
FINISH	
NOTES	CAN USED BE FOR LIFTING

## ADVANTAGES

- Galvanised - prevents premature rust and corrosion
- Good for use with many applications
- Highly durable
- Working load limit is embossed on the shackles so they comply with lifting safety standards

## DIMENSIONS (mm)

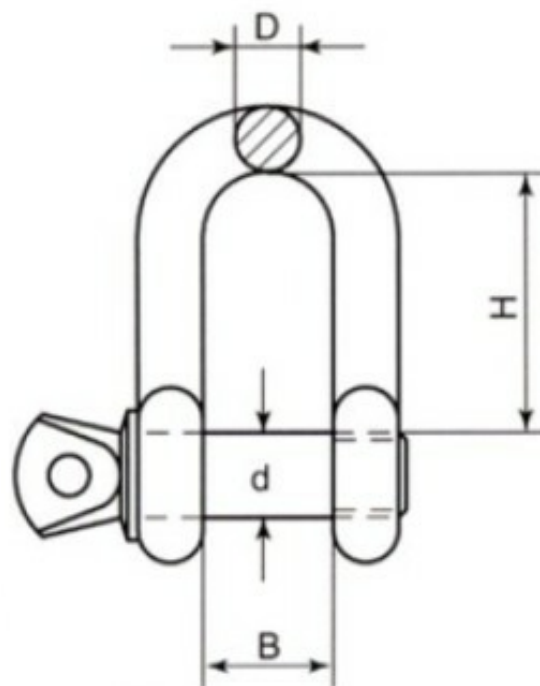

Code	SWL	D	d	H	B
39-050-G	0.50T	1/4"	5/16"	23	12
39-075-G	0.75T	5/16"	3/8"	27	13.5
39-100-G	1.00T	3/8"	7/16"	31	17
39-150-G	1.50T	7/16"	1/2"	37	18.5
39-200-G	2.00T	1/2"	5/8"	42	21
39-325-G	3.25T	5/8"	3/4"	51	27
39-475-G	4.75T	3/4"	7/8"	59	31
39-650-G	6.50T	7/8"	1"	72	36
39-850-G	8.50T	1"	1.1/8"	81	43
39-950-G	9.50T	1.1/8"	1.1/4"	91	46
39-1200-G	12.00T	1.1/4"	1.3/8"	95	51

### Notes about load limits where shown

**SWL or WLL = Safe working load limit (kg)** : This is the maximum weight the product should carry.

**BL = Break load** : This is the maximum weight to break for the product and will vary from batch to batch. You should only use the product at the WLL or 1/4 the break load.

The above are guides for sizing of products and not a recommendation.

Do not use any product for lifting unless drawing is marked suitable for lifting - with this symbol

