

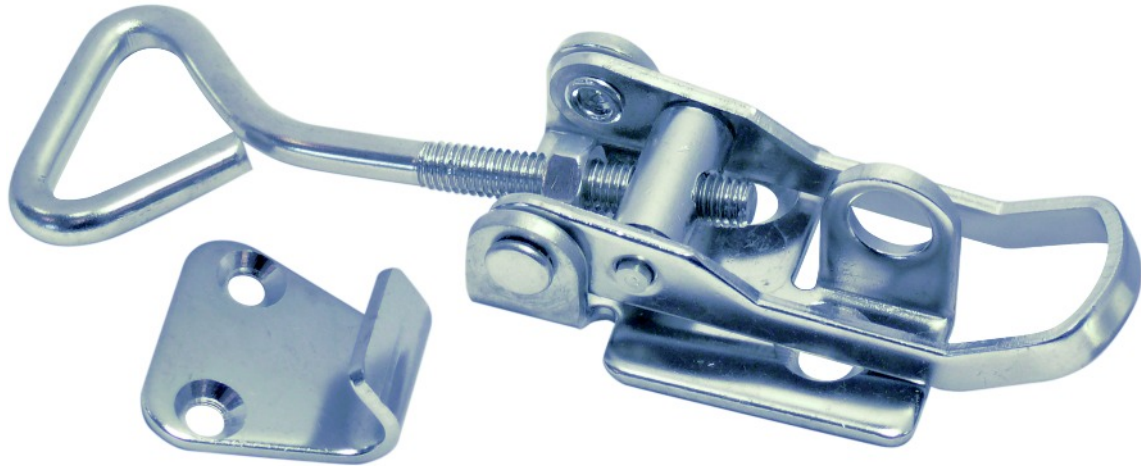

STEEL GEAR

Adjustable door latch



Door latch with tension bar

This style of toggle latch can be used where adjustment of the latch is possible after both parts of the latch are fitted. Can be opened easily and quickly with one hand. Padlock fitting hole makes this latch lockable if required. Can be used on cases and containers, enclosures and industrial machinery. Suitable for marine or food industry use.

MATERIAL	
MATERIAL TYPE	Stainless - A4 grade
FINISH	Polished / Shiney

ADVANTAGES

- Sturdy construction
- Will not rust
- Strong fixing points
- Easy to use with one hand
- Adjustable

DATASHEET

www.steelgear.co.uk

info@steelgear.co.uk

SPECIFICATION :

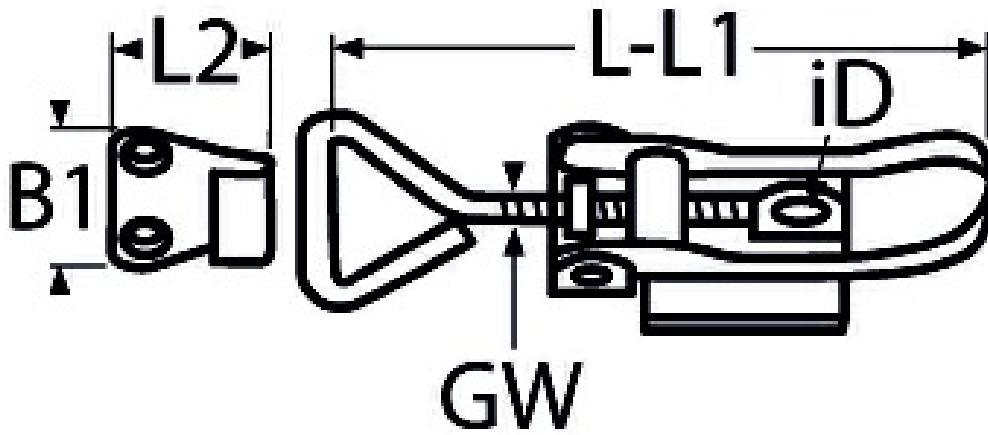

Code	L-L1	L2	B1	iD	Weight (g)
LAT2-85-A4	85-96	20	26	6.5	46