

Round Eyeplate

**BUY
ONLINE**

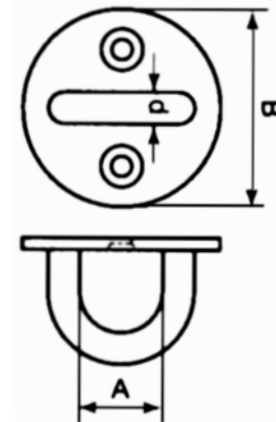

Available in :

○ A2 Stainless

Note :

● A4 Stainless
To special
Order only

Size (d)	Code	Weight (g)	B	A	Hole Ø
5	SKU6120	24	33	13	4
6	SKU6160	38	40	17	5
8	SKU6180	68	50	20	6

Notes about load limits where shown

SWL or WLL = Safe working load limit (kg) : This is the maximum weight the product should carry.

BL = Break load : This is the maximum weight to break for the product and will vary from batch to batch. You should only use the product at the WLL or 1/4 the break load.

The above are guides for sizing of products and not a recommendation.

Do not use any product for lifting unless drawing is marked suitable for lifting - with this symbol



**STEEL
GEAR**
Stainless steel fasteners & fittings

NB. This drawing and its dimensions to be used as a guide. For dimension critical applications please ask

STEELGEAR.CO.UK
UNIT 9 THESIGER CLOSE
WORTHING
BN11 2RN

www.steelgear.co.uk
info@steelgear.co.uk

Steelgear is a trading name of DARAC LTD

Title:

Round Eyeplate

Dimensions in mm

SIZE

A4

DWG NO.
PART NO.

See CODE in above table

REV

1