

FLAG POLE CLEAT

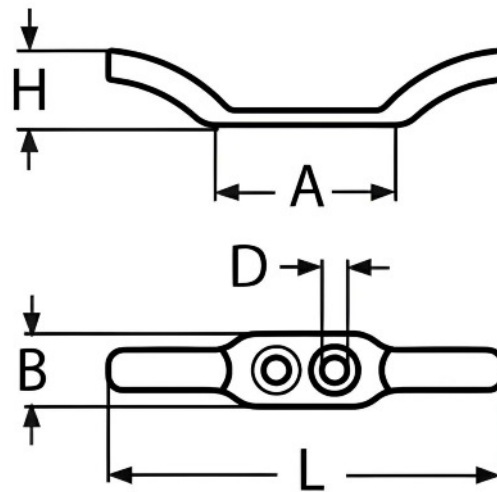

CODE	L	B	A	H	D
5275-50-A2	50	10	22	10	3.7
5275-80-A2	80	10	38	19	5

Notes : Dimensions are a guide and may vary slightly. Pls check with us for dimension critical applications.

If Break (BL), Safe working load (SWL) or Working load limit (WLL) are shown:
This is a guide only. (Do not use for lifting unless it is a certified lifting product)

FLAG POLE CLEAT

Our A2 stainless steel flag pole cleats are essential accessories designed for securely fastening flags to poles in various outdoor settings. Constructed from high-quality A2 stainless steel, known for its excellent corrosion resistance and durability, these cleats are ideal for use in both marine and terrestrial environments - although they won't corrode in the sea, they will tarnish. They are available in different sizes to accommodate various flagpole diameters and flag sizes, ensuring versatile application across different flag display setups. The design of A2 stainless steel flag pole cleats ensures reliable attachment of flags, providing stability against wind and other weather conditions. We offer them in 2 sizes; small (50mm) or large (80mm)

MATERIAL TYPE	A2 STAINLESS
FINISH	POLISHED

ADVANTAGES

- Good for various applications
- Highly durable