

GALVANISED DEE SHACKLE

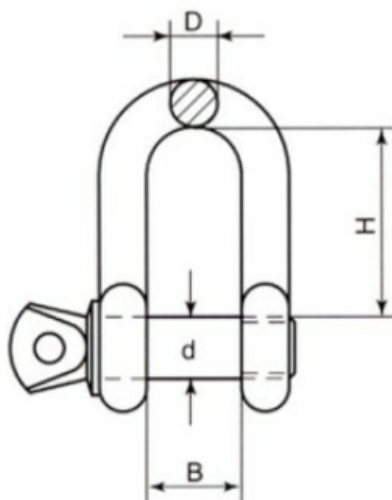

Code	SWL	D	d	H	B
39-050-G	0.50T	1/4"	5/16"	23	12
39-075-G	0.75T	5/16"	3/8"	27	13.5
39-100-G	1.00T	3/8"	7/16"	31	17
39-150-G	1.50T	7/16"	1/2"	37	18.5
39-200-G	2.00T	1/2"	5/8"	42	21
39-325-G	3.25T	5/8"	3/4"	51	27
39-475-G	4.75T	3/4"	7/8"	59	31
39-650-G	6.50T	7/8"	1"	72	36
39-850-G	8.50T	1"	1.1/8"	81	43
39-950-G	9.50T	1.1/8"	1.1/4"	91	46
39-1200-G	12.00T	1.1/4"	1.3/8"	95	51

Notes : Dimensions are a guide and may vary slightly. Pls check with us for dimension critical applications.

If Break (BL), Safe working load (SWL) or Working load limit (WLL) are shown:

This is a guide only. (Do not use for lifting unless it is a certified lifting product)

GALVANISED DEE SHACKLE

Galvanised Dee shackle made to U.S. Fed spec. RR-C-271. Every shackle has a safe working load limit which is embossed onto the shackle. It has a screw pin lock which is common with many types of shackles.

MATERIAL TYPE	A4 STAINLESS
NOTES	CAN BE USED FOR LIFTING

ADVANTAGES

- Galvanised - prevents premature rust and corrosion
- Good for use with many applications
- Highly durable
- Working load limit is embossed on the shackles so they comply with lifting safety standards