

## Load Rated Bow shackle (Safety pin)

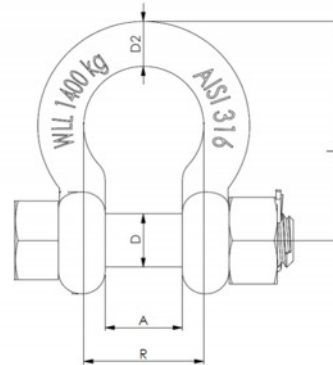

### COMES WITH DECLARATION OF CONFORMITY

SWL Kg	Code	Weight (g)	A	D	L	R	D2	Bolt
350	122-350-A4	25	9.7	6.4	25	15	5	M6
600	122-600-A4	50	12	8	31	19	6.4	M8
950	122-950-A4	94	13.5	9.5	36	21	8	M10
1400	122-1400-A4	170	17	11	42	26	9.5	M12

Notes : Dimensions are a guide and may vary slightly. Pls check with us for dimension critical applications.  
 If Break (BL), Safe working load (SWL) or Working load limit (WLL) are shown:  
 This is a guide only. (Do not use for lifting unless it is a certified lifting product)

### LOAD RATED SAFETY PIN TYPE BOW SHACKLE

This type of Bow shackle is forged and has a larger pin than standard BOW shackles. It has a working load limit allocated to it and comes with a certificate.

It has the working load limit and material etched onto the body so that it is clearly visible

It is excellent for use in applications where a load limit is required for the product

MATERIAL TYPE	A4 STAINLESS
FINISH	POLISHED
NOTES	CE CERTIFICATE

### ADVANTAGES

- High corrosion resistance
- Highly durable
- Load rated and forged for high strength