

## Load Rated Bow shackle (Screw pin)

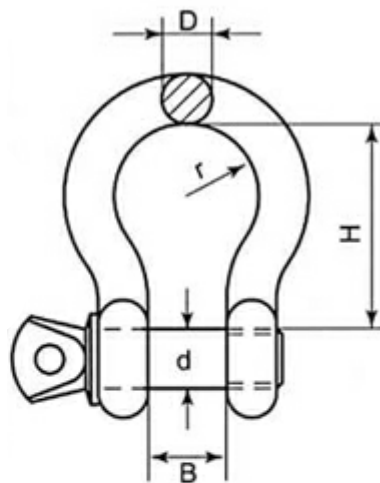

**COMES WITH DECLARATION OF CONFORMITY**

SWL Tonnes	Code	Weight (g)	B	H	2r	d
1	SKU1468	150	10	18	36	11
2	SKU1469	400	12	23	48	16
3	SKU1470	680	16	27	62	20
4	SKU1471	1100	20	30	72	22
5	SKU1472	1500	22	37	80	26
6	SKU1473	2610	25	44	95	28

Notes : Dimensions are a guide and may vary slightly. Pls check with us for dimension critical applications.

If Break (BL), Safe working load (SWL) or Working load limit (WLL) are shown:

This is a guide only. (Do not use for lifting unless it is a certified lifting product)

### LOAD RATED SCREW PIN TYPE BOW SHACKLE

This type of Bow shackle is forged and has a larger pin than standard dee shackles.

It has a working load limit allocated to it and comes with a certificate.

It is excellent for use in applications where a load limit is required for the product

<b>MATERIAL TYPE</b>	<b>A4 STAINLESS</b>
<b>FINISH</b>	<b>POLISHED</b>

### ADVANTAGES

- High corrosion resistance
- Highly durable
- Load rated and forged for high strength