

# Dee shackle with bolt and pin Load rated

**BUY  
ONLINE**

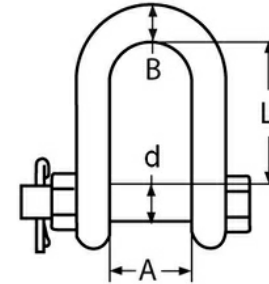

**Available in :**

● A4 Stainless

SWL Tonnes	Code	Weight (g)	B	A	L	d
1.32	5340-5	22	5	9.7	19	6.4
2	5340-6	44	6	12	22	8
3	5340-8	86	8	13.5	26	9.5
4	5340-10	151	10	17	32	11
8	5340-12	310	12	21	41	16
12	5340-16	634	16	27	51	19
16	5340-20	1018	20	32	60	22
20	5340-22	1589	22	36	71	25

**Notes about load limits where shown**

**SWL or WLL = Safe working load limit (kg) :** This is the maximum weight the product should carry.

**BL = Break load :** This is the maximum weight to break for the product and will vary from batch to batch. You should only use the product at the WLL or 1/4 the break load.

The above are guides for sizing of products and not a recommendation.

Do not use any product for lifting unless drawing is marked suitable for lifting - with this symbol 

NB. This drawing and its dimensions to be used as a guide. For dimension critical applications please ask



**STEELGEAR.CO.UK**  
**UNIT 9 THESIGER CLOSE**  
**WORTHING**  
**BN11 2RN**

**www.steelgear.co.uk**  
**info@steelgear.co.uk**

Steelgear is a trading name of DARAC LTD

Title:		
Dee shackle with bolt and pin Load rated with certificate		
Dimensions in mm		
SIZE	DWG NO. PART NO.	REV
<b>A4</b>	See CODE in above table	<b>1</b>