

# ASYMMETRIC SNAP HOOK

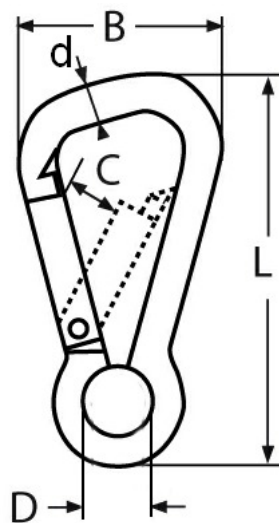

Code	d	L	B	C	D	Weight (g)	BL/kg
SHAS-6-A4	6	60	35	10	9	28.5	430
SHAS-8-A4	8	80	46.5	13	12	66	690
SHAS-10-A4	10	100	60	17	15	131	750
SHAS-11-A4	11	120	70	22	18	187	950

Notes : Dimensions are a guide and may vary slightly. Pls check with us for dimension critical applications.

If Break (BL), Safe working load (SWL) or Working load limit (WLL) are shown:  
This is a guide only. (Do not use for lifting unless it is a certified lifting product)

## Asymmetric snap hook

This type of snap hook has a wide and flat end and is therefore very suitable for applications involving webbing or double ropes. We also supply the same product with an eye at the small end.

See “Asymmetric snap hook with eye”

## ADVANTAGES

- Marine grade
- Will not rust
- Highly durable

MATERIAL TYPE	A4 STAINLESS
FINISH	POLISHED