

V-bolt with angled head

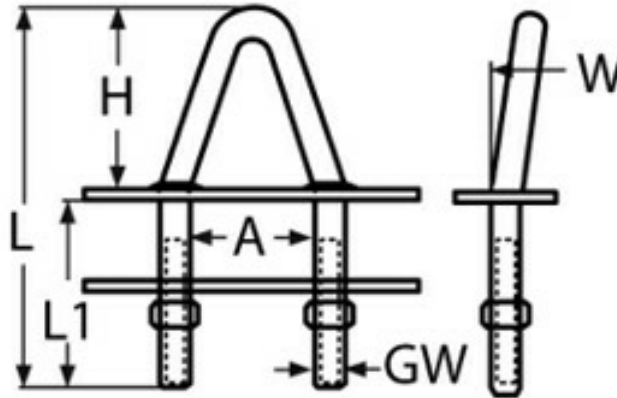

Strong U bolt with thick V section and 2 plates. With the two plates, it can be used to give a lashing point on the deck of the boat. The angled head makes side loading less likely, when Securing an item with rope. The top plate is fixed and welded.

Advantages

- ✓ 2 plated for deck use
- ✓ Different sizes and angles

MATERIAL

316 stainless steel

Code	W	GW	L	L1	A	H
5160-8A-A4	0°	M8	100	50	33	48
5160-8B-A4	8°	M8	100	50	33	48
5160-8C-A4	18°	M8	100	50	33	48
5160-10A-A4	0°	M10	120	60	40	58
5160-10B-A4	8°	M10	120	60	40	58
5160-10C-A4	18°	M10	120	60	40	58

DATASHEET