

**BUY
ONLINE**

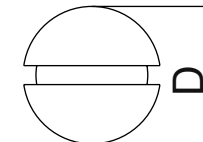
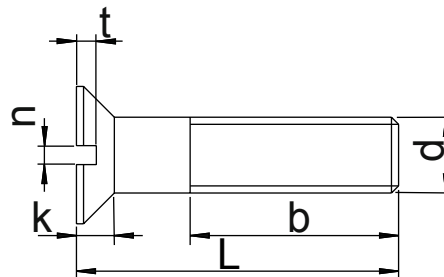

Available in :

○ A2 Stainless

● A4 Stainless

d	M1.6	M2	M2.5	M3	M3.5	M4	M5	M6	M8	M10	M12
dk	3	3.8	4.7	5.6	6.5	7.5	9.2	11	14.5	18	22
K max	0.96	1.2	1.5	1.65	1.93	2.2	2.5	3	4	5	6
n	0.4	0.5	0.6	0.8	0.8	1	1.2	1.6	2	2.5	3
t min	0.32	0.4	0.5	0.6	0.7	0.8	1	1.2	1.6	2	2.4
b min	15	16	18	19	20	22	25	28	34	40	46
ϕ	0.4X2.0	0.5X3.0	0.6X3.5	0.8X4.0	0.8X4.0	1.0X5.5	1.2X7.0	1.6X9.0	2.0X12	2.5X14	3.0X16

For part no. and length L

Please see website or catalogue

NB. This drawing and its dimensions to be used as a guide. For dimension critical applications please ask

**STEEL
GEAR**
Stainless steel fasteners & fittings

STEELGEAR.CO.UK
UNIT 9 THESIGER CLOSE
WORTHING
BN11 2RN
01903 331391
www.steelgear.co.uk
info@steelgear.co.uk

Steelgear is a trading name of DARAC LTD

Title:

DIN963
MACHINE SCREW
COUNTERSUNK FLAT HEAD SLOTTED

SIZE

A4

DWG NO.

FMS963

REV

1