

## Eyeplate Concave

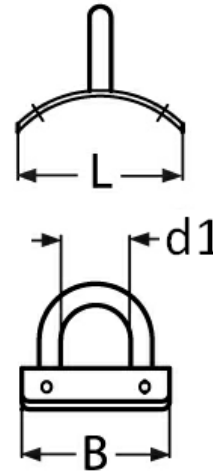

Code	L	B	d1
SKU6516	46.5	42	20
SKU6518	51	39	20

Notes : Dimensions are a guide and may vary slightly. Pls check with us for dimension critical applications.  
 If Break (BL), Safe working load (SWL) or Working load limit (WLL) are shown:  
 This is a guide only. (Do not use for lifting unless it is a certified lifting product)

### EYEPLATE CONCAVE

Made from 304 stainless steel. Can be used for many different things such as attaching ropes and cables.

<b>MATERIAL TYPE</b>	<b>A2 STAINLESS</b>
<b>FINISH</b>	<b>POLISHED</b>